



3 Bed  
House - Detached  
located in Pontefract

Offers In Excess Of £230,000



**enfields**



GROUND FLOOR  
444 sq.ft. (41.3 sq.m.) approx.



1ST FLOOR  
404 sq.ft. (37.6 sq.m.) approx.

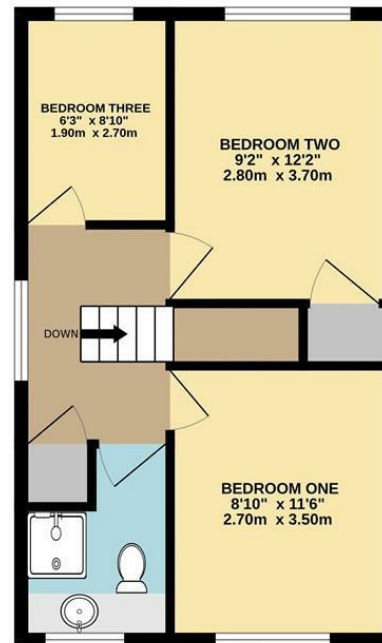

TOTAL FLOOR AREA: 849 sq.ft. (78.9 sq.m.) approx.

Whilst every attempt has been made to ensure the accuracy of the floorplan contained here, measurements of doors, windows, rooms and any other items are approximate and no responsibility is taken for any error, omission or mis-statement. This plan is for illustrative purposes only and should be used as such by any prospective purchaser. The services, systems and appliances shown have not been tested and no guarantee as to their operability or efficiency can be given.  
Made with Metroplan 6/2025

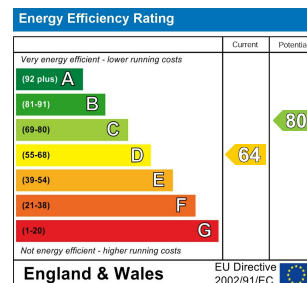

## DIRECTIONS

## CONTACT

30 Newgate  
Pontefract  
WF8 1DB

E: sales-pontefract@enfields.co.uk  
T: 01977 233124

# enfields